

Project

Princess Park, Shepparton



Project scoping and funding



Detailed design and procurement



Project construction

Construction complete and park opening late 2021

Key features

The Princess Park off leash dog park will include agility equipment, 1.8m high fencing, shelter, solar lighting, water fountain and litter bins.

Project partners

DELWP (\$157,568)

Greater Shepparton City Council (\$31,512 plus project design and delivery)

Location

Cnr Quinan Pde & Nixon St,
Shepparton



Design Concept

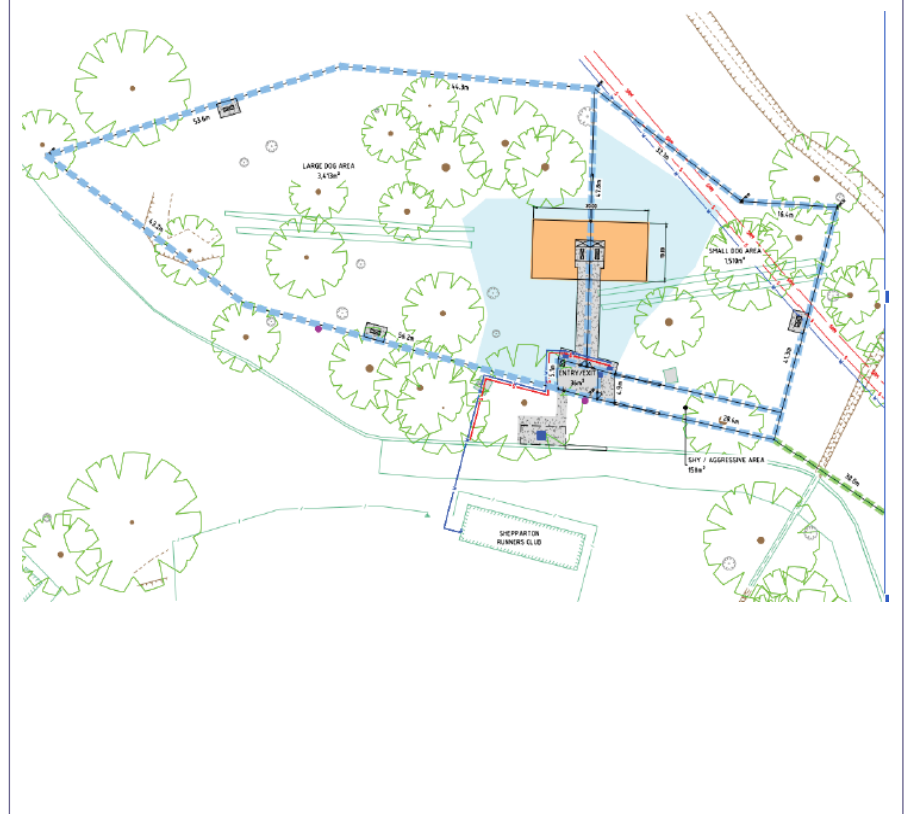

© The State of Victoria
Department of Environment,
Land, Water and Planning 2020



This work is licensed under a Creative Commons Attribution 4.0 International licence. To view a copy of this licence, visit creativecommons.org/licenses/by/4.0/

For more information

Web: www.environment.vic.gov.au/suburban-parks

Email: Local.Parks@delwp.vic.gov.au

Greater Shepparton City Council

Phone: 03 5832 9700 **Email:** council@shepparton.vic.gov.au

Web: www.greatershepparton.vic.gov.au

Last updated: July 2021